



# INTELLIGENT BIDET TOILET SEAT

## Product Manual

V8214



**Please note:**

This Bidet seat must be installed with a Reduced Pressure Zone (RPZ) Valve or other backflow prevention device, which is not supplied by Newtech. This is required to meet the Building Code requirements. Please consult with your registered Plumber.

# Table of Contents

Important Safety Guidelines	3
Safety Precautions	4
Precautions for use	8
<hr/>	
Installation Diagram	12
Installation Instructions	13
Control Knob Unit	14
Bidet Remote Control	15
LED Display Screen	16
Instructions for Use	17
<hr/>	
Disassembly and Cleaning	18
When not in use for a long time	19
Sterilization and Infrared Therapy	20
When there is a risk of freezing in winter	21
<hr/>	
Faulty Diagnosis	22
Product Specifications	23

# Important Safety Guidelines

Be sure to read the following safety guidelines carefully and use the product only as instructed in this manual to prevent bodily injuries and/or prevent property damage which might happen while using this product.

**HAZARD 1: To reduce the possibility of electric shock.**

1. Do not place or store the product in a place that may be wet.
  2. Do not drop the remote control into the toilet, bathtub, sink, or other liquids.
  3. Do not spray water onto the product or plug section.
  4. After use: wipe off the water on the toilet seat and use a ventilation system in the bathroom to avoid water condensation left on the toilet seat and plug.
- 





**WARNING 1:** To prevent the possibility of burns, electric shock, fire, and injury

1. Users (including children) with physical, sensory, intellectual disabilities or a lack of experience and common sense need to be accompanied when using the product, and please adjust the temperature to the lowest level or turn off the toilet seat temperature function. Children are prohibited from playing with this device.
2. The product is limited to the functions listed in this manual. Please do not use accessory equipment not recommended by Newtech.
3. Please do not continue to use this product if the wires or plugs of the product are damaged, the product malfunctions, the product is damaged, or it falls into water. Please contact Newtech Bathroomware on 0800 728 662 or [sales@newtech.co.nz](mailto:sales@newtech.co.nz)
4. Please ensure that the wires are not burned.
5. Do not use the product in a drowsy or sleeping state.
6. Do not drop or insert any items into the product opening or water pipe.
7. Do not use this product outdoors.

**Please save this safety guide**

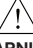
# Safety Precautions

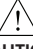
Please read this [safety precautions] carefully before using it correctly. The precautions listed here are important content related to safety. Please be sure to comply with them

The identification and meaning are as follows		Examples and explanations of icons	
 <b>WARNING</b>	If this sign is ignored and misoperated, it may cause serious injury or death to personnel.		Never disassemble or modify this product.
 <b>CAUTION</b>	If this sign is ignored and misoperated, it may cause personal injury or property damage.		Things that have to be observed

## **WARNING**



### **Do not pour water or detergent on the product or power plug**

- May cause fire or electric shock
- Do not install the product in wet or damp places. (This product is intended for use on a toilet only, and should not be used for any other purpose)

This product is an electrical product, so please do not install it in areas prone to water splashing or high humidity. When using in the bathroom, please install a ventilation fan or air outlet to maintain good air circulation in the bathroom.

- May cause fire or electric shock.

Please set the wall outlets for power wiring as follows

If wiring is not done according to the following requirements, it may cause a fire or electric shock.

**a.** Use an electric wall outlet independently which is suitable for AC 220V.

Use of an extension cord or sharing an outlet with another product may lead to fire or electric shock.

**b.** The installation position of the socket must be at least 0.3m above the ground and as far away from a wet area as possible - i.e bath or shower.



# WARNING



Dismantling prohibited

Never disassemble, repair or modify the product.

- May cause fire, electric shock or injury



No Wet Hands

Do not use wet hands to plug or unplug the power plug.

- Electric shock may occur.



Prohibit

Do not continue to use the product when it malfunctions

When the following situations occur, please unplug the power plug, close the water inlet angle valve, and stop the water inlet.

Fault:  
Body leakage  
Cracks and cracking of the product  
Abnormal sound or odor appears  
Product smoking  
Abnormal heating of the product  
Clogged toilet

- If it continues to be used in the event of a malfunction, it may cause problems such as fire, electric shock, or indoor water seepage.



Prohibit

Do not damage the power cord or toilet connection cable.

Do not pull, do not heat, do not forcefully bend, do not place heavy objects on the power cord and toilet connection line.

- Ignoring product damage and continuing to use it may result in a fire, electric shock, or short circuit. If the power cord is damaged, it needs to be repaired by a professional.



Prohibit

Do not use loose and unstable wall outlets

- May cause fire or electric shock



Prohibit

Do not use multiple electrical sockets

- Do not connect wires or use extension cords midway, as it may cause fire, and electric shock.



Prohibit

Do not use water sources other than tap water

- May cause skin inflammation and other issues



Prohibit

Do not use power sources other than 220V AC

- May cause fire



# CAUTION

## Pay attention to low-temperature burns

- If you are sitting on the toilet seat for a long time, please adjust the temperature of the toilet seat to the position where the seat temperature indicator light is off.

- When the following personnel use heated toilet seats and warm air drying, please adjust the temperature of the toilet seat to the off position of the indicator light, and adjust the warm air temperature to the off state on the air temperature indicator light.

Children and elderly people cannot adjust their temperature to the appropriate level on their own. As well as patients, people with disabilities, and others with limited mobility. Sleepy individuals who have taken hypnotic drugs (such as sleeping pills and cold medications), consumed deep alcohol, and experienced excessive fatigue.



## WARNING



Prohibit ignition

- Do not allow cigarettes or other sparks to approach the product
  - May cause a fire
- 



Prohibit

- Do not use your fingers or other objects to place or block the heating air outlet
  - Do not use your hand to block the warm air outlet, and do not cover the warm air outlet with clothes, etc
  - May cause burns, electric shock and burning.
  - Children are prohibited from playing with this device.
- 



Prohibit

- Please do not apply strong force or impact, do not stand on the toilet seat, and do not place heavy objects on the toilet seat
- It may cause product cracking, body detachment, and personal injury.
- Damaged toilets can cause indoor flooding.
- The user of this bidet product should not weigh more than 120kg

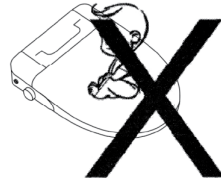

Prohibit

- During cleaning, please use diluted cleaning products (neutral) and do not use the following products.  
(Acidic or alkaline bathroom detergent, benzene, thinner, cleanser or nylon scrubber)
  - It may damage plastic and cause it to crack, causing personal injury.
  - May damage water pipes and cause water leakage.
- 



Prohibit

- Do not use the bidet seat to rinse anything except for bowel movements and urination
  - Otherwise, it may cause blockage of the toilet seat and overflow of sewage.
- 



Prohibit

- Do not twist or damage the water inlet hose
- May cause water leakage

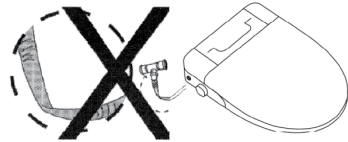



Must comply

When not in use for a long time, please disconnect the power.

- For safety reasons, please unplug the power plug.
- When used again, corrosive water can cause skin inflammation, etc. Please add water again before use.



Must comply

When water leakage occurs, please close the inlet angle valve and stop the water inlet.



Must comply

Preventing damage caused by freezing  
- Freezing can cause damage to the water inlet configuration and the interior of the body, resulting in water leakage.



Must comply

Please tighten the inlet filter securely when installing it

- Otherwise, it may cause water leakage

Please implement insulation measures to increase the temperature of the toilet.



Must comply

### Insert the power cord plug properly

- Before use, please ensure that the power cord plug is properly plugged in, and the plug should be tightly attached to the wall outlet without any looseness or incomplete insertion, otherwise it may cause an unexpected fire.

- When not using this product for a long time, please unplug the power plug.



Must comply

### Do not expose this product to direct sunlight

- Easy to cause discoloration, aging, and cracking of the product.

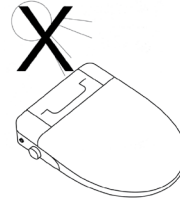

# Precautions for use

Please be sure to follow the following instructions

## Cause of damage

Use a dry cloth to wipe the product body, toilet seat and cover.

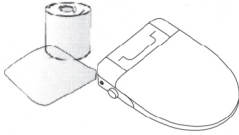

It is strictly prohibited to rinse directly with water.

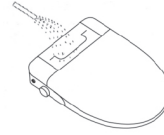

## Fault cause

Do not pour urine on the body or nozzle.



When thunder strikes, please unplug the power plug.

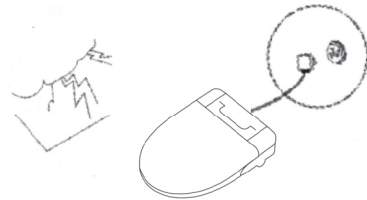

## Poor movement

Do not cover the sending and receiving signals of the seat sensors, human body detection sensors, and remote controls.

- May cause incorrect operation of the bidet toilet seat.

## Do not rest against the seat cover when sitting on the seat

- May cause the seat cover to break, which may lead to injury.

Please be sure to follow the following instructions

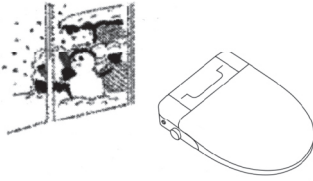

At night when freezing may occur, to prevent damage caused by freezing, please take anti freezing measures.

---



Please do not place heaters near the body.  
- Discoloration or malfunction may occur

---



Please do not roughly open the seat or cover  
- Cracking or malfunction may occur

Please confirm the below before using the Newtech Intelligent Bidet Toilet Seat for the first time

Insert the power plug into the wall outlet	Confirm if the inlet valve is open
<p>1. Insert the power plug into an AC 220V socket.</p> 	<p>3. Confirm whether the inlet valve to the bidet toilet seat inlet hose is installed in place correctly.</p> 
<p>2. Confirm if the status indicator light and power light are on</p> 	<p><b>⚠ WARNING</b></p> <p><b>Do not use power sources other than 220V AC. Please wire according to relevant regulations.</b></p> <p>*Easy to cause fire* </p>

**⚠ WARNING**

The power plug of this product is a three-phase plug (with a earthing wire). There is a risk of electric shock when a malfunction or leakage occurs when there is no earth wire plug on the outlet, please consult with your registered electrician.



## Confirm various functions

1. Check whether the nozzle and its water pipe are not leaking. After wiping all parts of the water pipe, use absorbent paper to check.
2. Check if there is a “beep” sound from the buzzer when pressing the seat sensor on the seat ring.
3. Check if the cleaning and drying functions are normal.
4. Check whether the damping and buffering mechanism is normal.

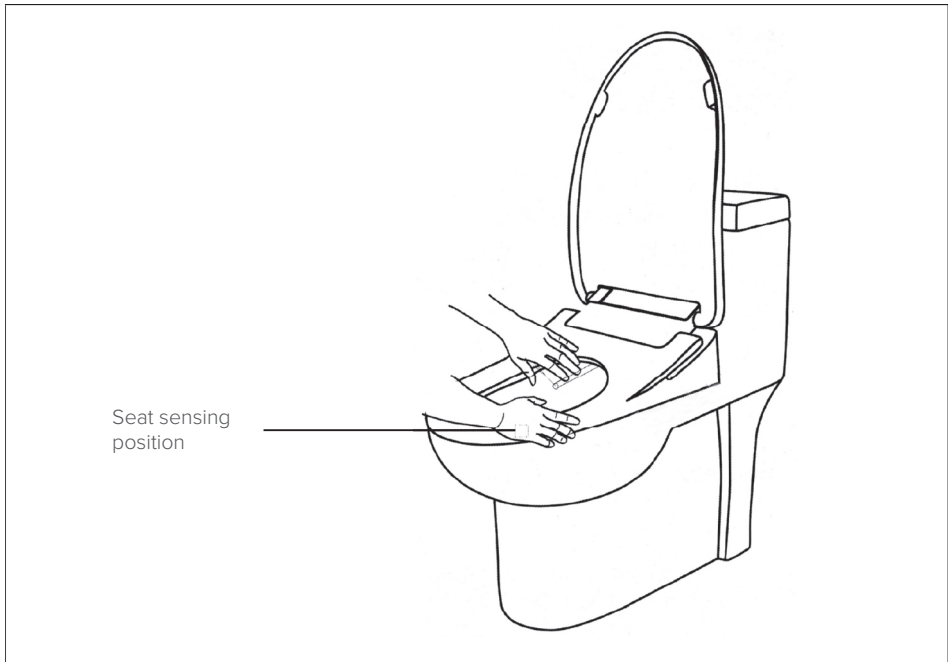

- When checking, cleaning, and drying, it should be confirmed that the seat sensor is activated.
- When cleaning, cover the front end of the nozzle to prevent splashing.

# Installation Diagram

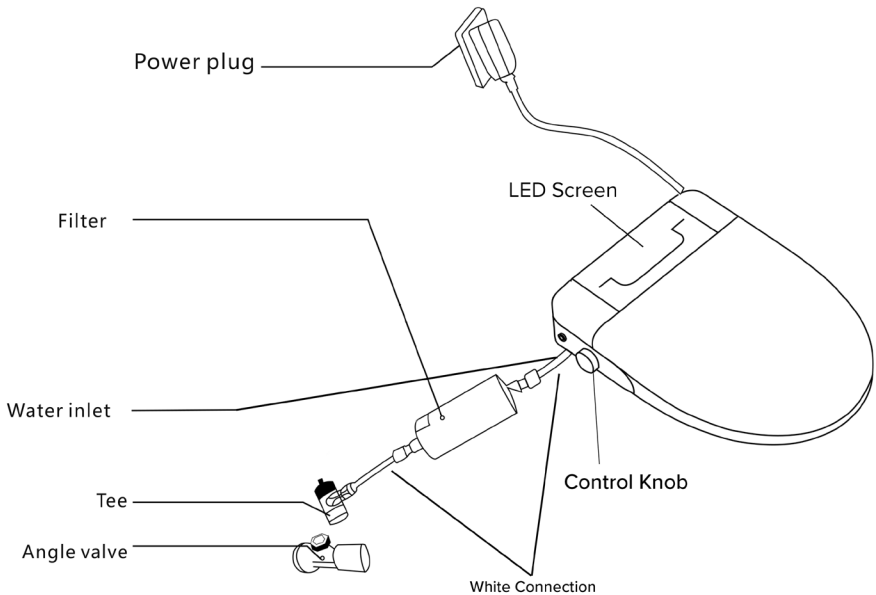

1. One end of the tee is screwed onto the angle valve, and the other end is threaded and connected to a ceramic braided hose.
2. One end of the three-way quick connector is twisted into the filter, and the other end of the filter is connected to the bidet toilet seat through a quick connector.
3. Open the angle valve, turn on the three-way switch, and plug in the power plug.

**Please Note:** The water filter does not have to be used. This is an optional add on only.

## Precautions for installaion technicians:

1. Before installation, please open the corner valve to drain the sediment and sewage in the water pipe for 2-3 minutes before installation, to avoid causing internal blockage of the toilet cover and causing the spray pipe leakage, dripping.
2. The filter should be aligned with the water inlet and outlet, and cannot be installed backwards.

# Installation Instructions

*Important: This Newtech Intelligent Bidet Seat must be installed in accordance with AS/NZS 3500.1 Plumbing and Drainage – Water Services*

**This Bidet seat must be installed with a Reduced Pressure Zone (RPZ) Valve or other backflow prevention device, which is not supplied by Newtech. This is required to meet the Building Code requirements. Please consult with your registered Plumber.**

**- Must be installed by a registered plumber and registered electrician**

**- Suitable for Casalino Toilet Only**

## Install the toilet seat:

1. Remove the existing toilet seat. To remove the existing toilet seat, untighten the seat bolt screws using a screwdriver.
2. Place the fixing plate onto the toilet pan. When this is in place, insert the bolts through the mounting bracket into the toilet pan holes
3. Push the Bidet toilet seat into the fixing plate until it is clicked into place

*Please note: Do not install or un-install the bidet toilet seat by holding just the toilet seat lid. If doing so this may cause cause mechanical failure.*

## Connect the Water Supply:

1. Turn off the water supply
2. Connect the water supply hoses to the bidet seat and inlet valve. Ensure that all the sealing rings are loaded (water filter is optional)
3. Turn on the water supply and check for any water leaks

## Connecting the Power:

1. Insert the power plug into the wall outlet.
2. Press the “Reset button” on the RCA surge protector to turn the power on.
3. Press the “Test Button” on the RCA surge protector to turn the power off.

***Please note: Please make sure the plug and your hands are dry before connecting the power supply.***

# Control Knob Unit

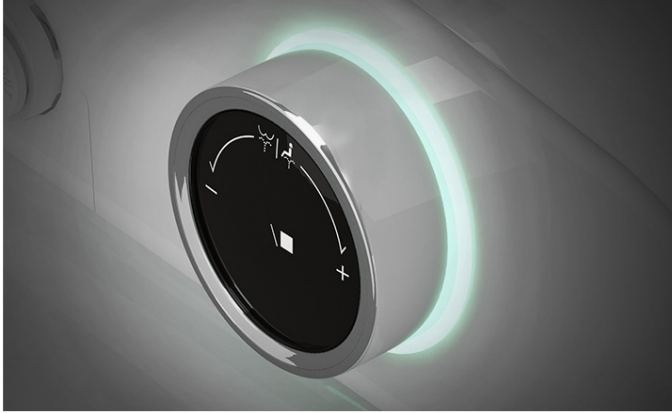

## Knob Colour Light:

- **Green:** Standby
- **Red:** Drying
- **Purple:** Feminine Wash
- **Blue:** Posterior Wash
- **Light Blue:** Sitting detected



**Feminine Wash and moving/massage wash**  
(clockwise rotation)



**Single press** (stop function)



**Drying**  
(Long Press while seated)



**Posterior Wash and moving/massage nozzle**  
(counterclockwise rotation)

When seated, the human body needs to contact the sensing area, otherwise it will not be able to use functions such as cleaning and drying (the sensing point must be covered before using the nozzle and drying).

If human body leaves the sensing point, the nozzle will stop working.

# Bidet Remote Control

Smart remote control with display screen. The user-friendly interface and clearly labelled buttons allow for intuitive operation and effortless control of various modes

- Can be wall mounted
- Require 2x batteries (not supplied)

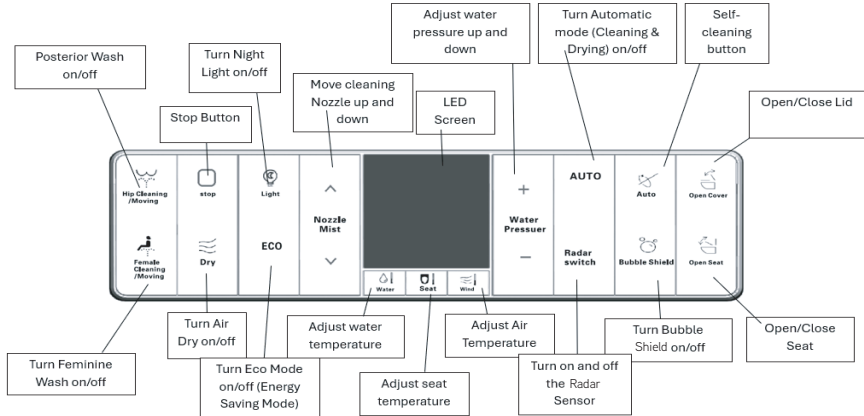

## Controls Information

- Posterior Wash Button – Turn on cleaning for 90 seconds. Double clicking this button will turn on mobile/massage cleaning effect as water moves back and forth
- Feminine Wash Button – Turn on cleaning for 90 seconds. Double clicking this button will turn on mobile/massage cleaning
- Stop Button - Turn off any function that is active.
- Air Dry Button - turn on air drying for 180 seconds.
- Eco Mode Button – turn on and off Energy Saving Mode
- Night Light Button – turn on and off the night light. Selecting this function will allow the night light to turn on when there is no other light on in the room.
- Nozzle Mist Button – adjust the nozzle to a comfortable position (4 positions available)
- Water temperature button – adjust the water temperature up and down. (4 temperatures available – room temperature, low (35°C), medium (37°C) and high (40°C))
- Seat temperature button – adjust seat temperature up and down. (4 temperatures available – room temperature, low (35°C), medium (37°C) and high (40°C))
- Air temperature button – adjust air temperature up and down. (4 temperatures available – room temperature, low (35°C), medium (37°C) and high (40°C))
- Water Pressure button – adjust the water pressure up and down.
- Automatic Mode Button – turn automatic mode on and off. When this is selected cleaning mode will automatically turn on for 90 seconds then drying mode will automatically turn on for 180 seconds
- Self-Cleaning Button – Turn on and off the self-cleaning for the Nozzle.
- Radar Sensor Button – Turn on and off the Radar Sensor. Selecting this function will allow the radar to sense a human approaching the toilet which will open the toilet lid and then close the toilet lid when no one is in the room.
- Bubble Shield Button – Turn on and off the bubble shield. Selecting this function will allow the seat to spray bubbles around the toilet seat when you sit on the seat and when you leave the seat for a cleaner experience.
- Open/Close Lid Button – Open and Close Lid
- Open/Close Seat Button – Open and Close Seat
- LED display Screen - this screen will show all the functions that have been selected and the temperature of these functions.

# LED Display Screen



- Water temperature and seat temperature will be displayed on the screen
- Closed or open seat symbol will be displayed
- Cleaning or drying symbol will be displayed
- Eco Symbol will be displayed if this function is active.

After leaving the seat for 3 minutes, the display screen lights, knob lights and ambient lights will automatically turn off.

## Entering Sleep Mode:

Display Screen will turn on when the toilet seat is closed and then the display screen will turn off after 3 minutes and will enter sleep mode

# Instructions for use

## Energy saving function

The following measures can effectively save energy

After use, lower the seat cover

- Don't blindly set the seat temperature to the highest temperature (40 degrees)
- Adjusting to a level that does affect comfort is best.
- Spring, summer, autumn, and winter, please adjust according to the temperature
- This machine has an automatic sleep function after 3 minutes.
- When there is a possibility of freezing, please take anti freezing measures

---

## Slowly close the seat ring and cover

The bidet toilet seat is equipped with a damping and buffering device to prevent collision noise when closing the seat ring.

---

## Seat sensor

Because there is a seat sensor installed, even if the switch is pressed by mistake when not seated, the spray will not spray water, and the functions of posterior cleaning and feminine cleaning will not be activated until the seat is seated. The seat sensor cannot operate if the following conditions occur.

- Not seated within the range of the sensor sensor.

\*Please change the seating position if this occurs

## There is water flowing out around the nozzle

Before and after cleaning or when the warm water switch is set to on, water appears around the nozzle, which is normal in terms of structure and not a fault.



\*In addition to the above situations, if there is continuous water flow, please close the inlet valve, unplug the power plug from the socket, and contact your registered plumber.

---

## Remote control

When the battery is about to run out of power, the indicator light on the remote control will dim or not display, and the remote control operation cannot sense. Please replace the battery in a timely manner.

# Disassembly and Cleaning

## Disassembly method of bidet toilet seat

1. Remove the power plug from the wall outlet.

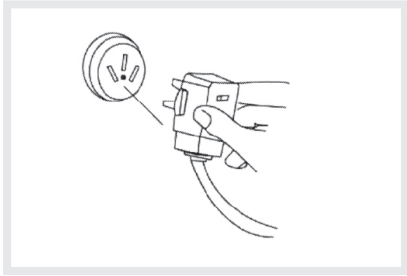

2. Close the inlet valve and stop the water supply.

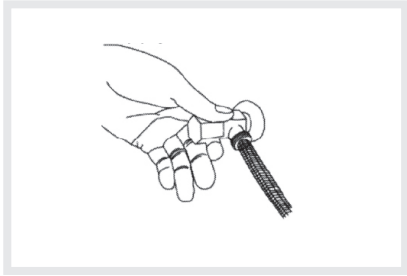

3. Press the installation button on the right side of the bidet toilet seat, then pull the cover body forward to remove the bidet toilet seat

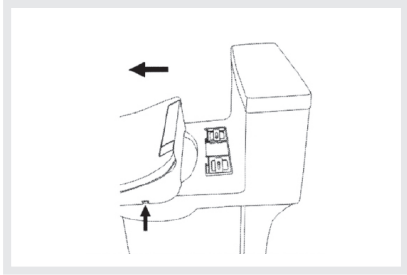

4. Gently place the bidet toilet seat on a soft ground.

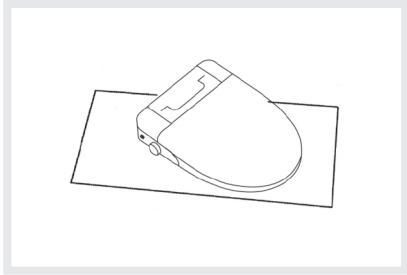

### **WARNING**

1. Be sure to unplug the power plug from the wall outlet.
  - Dry burning of the power plug can cause smoke or fire.
2. Please do not connect external power cords or water supply pipes to the body.
  - Can cause damage or leakage.
3. Please be careful when removing the bidet toilet seat for cleaning.
  - Can cause leakage and malfunction
4. Never uninstall the bidet toilet seat without unplugging the power, and do not place it directly on the ground.
  - May cause surface scratches or malfunctions.

- Do not place the Bidet Toilet seat upside down on the ground.
- May cause product malfunction.



# When not in use for a long time

Please make sure to drain the water in the following situations.

- Not using bidet toilet seat for extended periods of time due to travel. (Water pollution can cause blockage)
- When not in use for a long time, in a cold location. (In uninhabited residential areas, the temperature drops faster than expected and is prone to freezing and water leakage)

## Drainage and cutting off power supply

1. Close the water inlet valve and stop the water inlet.

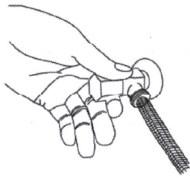

2. Drain the water from the water supply hose.

- Place containers under the inlet valve.
- Remove the water supply hose from the inlet valve and place the end of the water supply hose into the container.

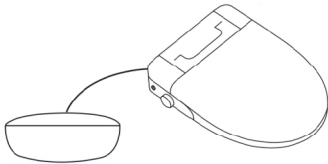

3. Remove the power plug from the wall outlet.

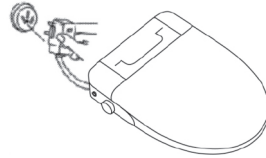

4. When unscrewing the drainage bolt, drain the water from the small water tank inside the bidet toilet seat, and then screw the bolt back in place.

5. When reusing, be sure to perform a trial run.

### If freezing occurs and water cannot be sprayed out

In case the water supply hose or water supply connection freezes and no water is sprayed, cover the hose or water supply connection with a cloth soaked in hot water to thaw it out, or increase the indoor temperature and wait for it to thaw out naturally.



## CAUTION

When removing the water supply hose, Be sure to close the inlet valve. When installing the water supply hose, please insert it in place correctly.

\*Easy to cause water leakage and indoor water accumulation



## CAUTION

Do not pour hot water or hot air on the water supply hose

\*May cause damage to the main water supply pipe

# Sterilization and Infrared Therapy

## Spray rod sterilization:

1. The default automatic sterilization function is effective when powered on; within 5 seconds of shutting down, press and hold the water temperature button to turn on and off automatic sterilization
2. In the closed state, press and hold the water temperature button to activate manual sterilization

## Infrared therapy:

Press and hold the seat temperature button for 30 seconds to start the physical therapy while in the Posterior or Feminine wash mode.

# When there is a risk of freezing in winter

In cold winter, the bidet toilet seat may get damaged or leak due to the freezing of water inside the bidet toilet seat holder.

To prevent freezing damage, please proceed as follows.

## General measures to prevent freezing

1. Switch the water temperature switch and seat temperature switch to (high) and close the seat cover.

2. Turn on heating indoors.

- If there is no heating indoors, please drain the water from the water supply hose according to the following method.

a. Close the inlet valve and stop the water supply.

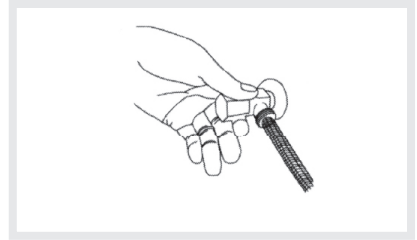

b. Drain the water from the water supply hose.

Place containers under the drain valve.

Remove the water supply hose from the inlet valve and place the end of the water supply hose into the container

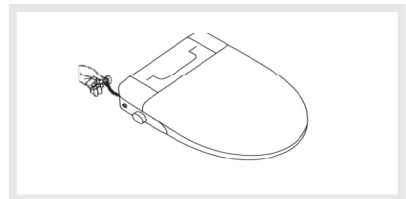

After the drainage is completed, please insert the water supply hose effectively.

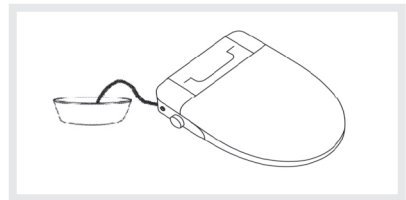

c. When reusing, please make sure to perform a trial run.



## CAUTION

When disassembling the water supply hose, be sure to close the inlet valve. When installing the water supply hose, please insert it in place.

\*Easy to cause water leakage and indoor water accumulation.



## If freezing occurs and water cannot be sprayed out

In case the water supply hose or water supply connection is frozen and unable to spray water, please cover the water supply hose or water supply connection with a cloth soaked in hot water to thaw it, or increase the indoor temperature and let it naturally thaw.



## CAUTION

Do not pour hot water or blow hot air onto the water supply hose.

May cause damage to the main water supply pipe.

# Fault diagnosis

If there are some faults that can be eliminated through simple operations when deemed faulty, please confirm the following items before commissioning repairs.

Fault	Reason	Troubleshooting
Unable to spray water	The power socket is not powered on	Confirm if there is a power outage
	The power switch is in the (off) state	Press the power switch to turn on the power light in the display area of the body
	The power plug is not inserted into the wall outlet	Plug in the power plug in correctly
	Leakage occurs	Please unplug the power plug and contact your registered plumber
	The inlet valve is in a closed state	Open the inlet valve
	Filter mesh clogged	Clean the filter screen
	The connection to the water inlet pipeline is blocked due to twists and turns	Straighten the water pipes
	Not falling within the limited range of the seat sensor	Adjusting the seating position
	Blocked cleaning nozzle	Disinfection nozzle
	Freezing of water supply hoses, etc	Please use a cloth soaked in warm water to heat the water supply hose and water supply connection. Or increase the indoor temperature until it naturally thaws out
The spray water is too hot	The water temperature is not set at the appropriate temperature	Press the water temperature button to adjust to the appropriate temperature
The seat ring is not warm	Seat temperature is not set at a suitable temperature	Press the seat temperature button to adjust to the appropriate temperature
Lights keep flashing		To indicate component failure, please contact after-sales service

If the malfunction cannot be immediately resolved through the above troubleshooting, please contact **Newtech Bathroomware** on **0800 728 662** or **sales@newtech.co.nz**

# Product Specifications

Category		Specifications	
Rated voltage		AC 220V ± 10%, 50HZ/60HZ	
Power		1050W (at inlet temperature of 15°C and 240kpa)	
Cleaning function	Water yield	Posterior cleaning	Approximately 700ml/min
		Feminine cleaning	Approximately 700ml/min
	Outlet water temperature	Room Temperature, 35°C, 37°C, 40°C	
	Warm water heating method	Instant heating	
	Heater power	Dual section 800W + 800W	
	Safety devices	Inlet/outlet water temperature sensor, liquid level switch, flow meter, leakage protector, temperature controller	
Drying function	Warm air temperature	Room temperature 35°C, 37°C, 40°C	
	Wind speed	6800 RPM	
	Heater power	Approximately 220W on average	
	Safety devices	Bimetal sheet, temperature fuse	
Seat ring heating	Seat ring temperature	Room temperature 35°C, 38°C, 40°C	
	Heater power	50W	
	Safety devices	Temperature sensor, temperature fuse	
Deodorization	Type	Activate carbon high-efficiency catalyst filter	
Mobile cleaning		The nozzle moves 1.5cm back and forth	
Nozzle position		Adjustable front and rear	
Water supply temperature		0-39°C	
Static pressure of water supply		150-750kPa	