

SPECIFICATION SHEET

Vega 750mm 2 Drawer Floor Vanity



Features

- Floorstanding
- Full Extension Soft Close Drawers
- Negative detail finger pull with extrusion
- Cabinet:
 - Laminate Woodgrain & Solid Colours on MR Board
- A variety of slab top options

- Dimensions: H820 x W750 x D465
- Floor plumbing provision has been allowed for with a 60mm space behind lower drawer. Note lower drawer DOES NOT have a plumbing cutout and is designed to offer full storage space.
- **Optional: Floor plumbing waste provision in bottom drawer [88515] - Additional cost applies**

*Note: Vessel basins are purchased separately.
Visit www.newtech.co.nz for full range of vessel basin options.*

Technical Details

Note: All measurements shown are in millimetres. Sizes are nominal.

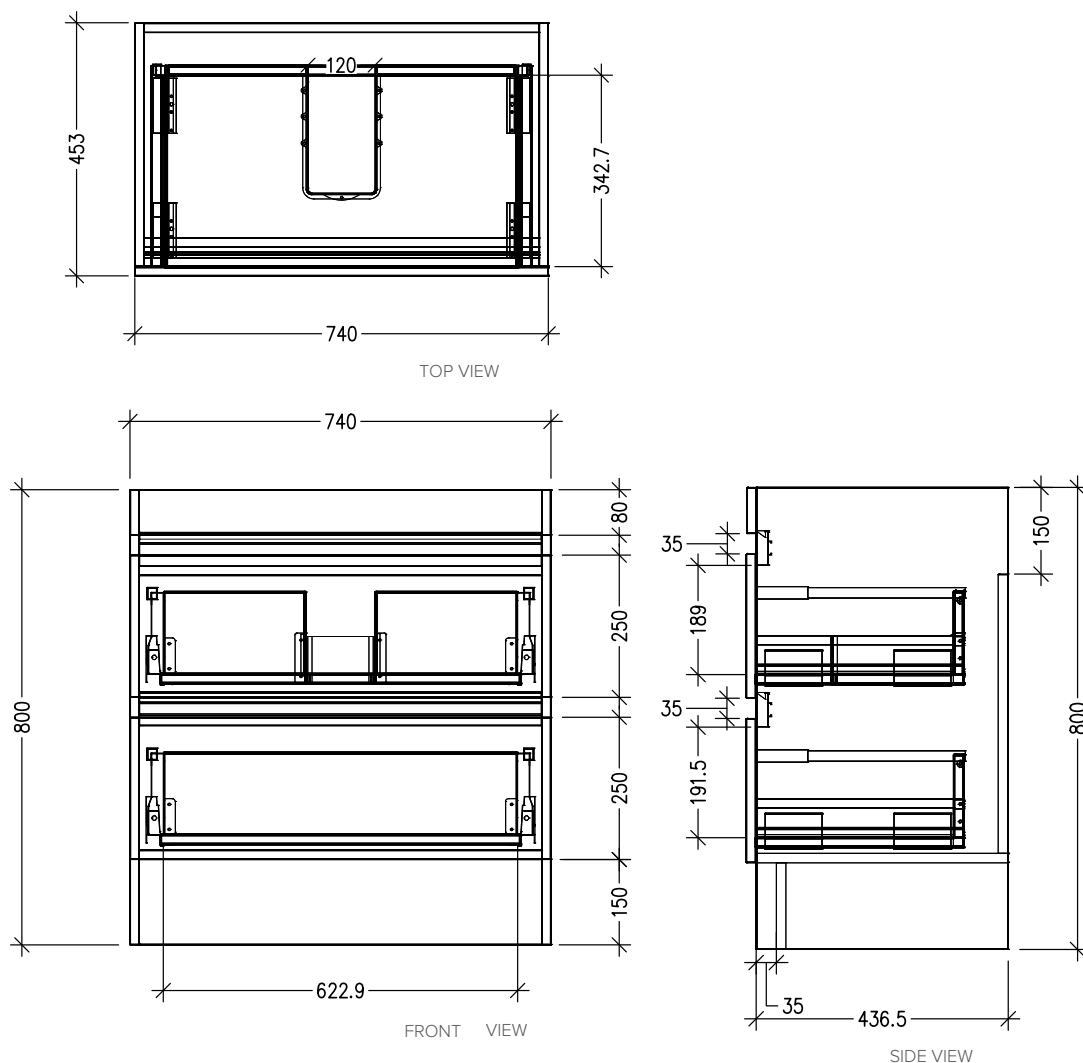

SPECIFICATION SHEET

Slab Top Options

Slab Top 750

W750 x D465 x H20

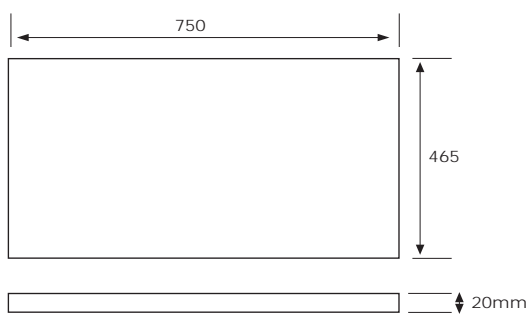

Note: Refer to www.newtech.co.nz for slab top options