



FREESTANDING & BACK-TO-WALL BATHS

Installation Instructions & Warranty Information

IMPORTANT:

Please read the following instructions carefully before commencing installation. Qualified tradesmen must carry out all plumbing works and **all aspects of the installation process should be in accordance with the building code.**

Head Office & Manufacturing Centre

30 Mill Road, Whanganui
0800 728 662
sales@newtech.co.nz
www.newtech.co.nz

For optimum results the bathroom floor should be level. If an acrylic bath is going to be placed below a bath to ceiling window, where it is exposed to direct and full sunlight, we recommend painting both inner front side walls of the bath. This is to minimise sunlight penetrating through the bath creating shadow lines.

To aid the installation the use of a low profile 2-piece bath waste is recommended.
Refer to Newtech Evoke 2-Piece 40mm Bath Waste - Product Code: 2280.

1. Newtech baths are supplied on an integrated support with adjustable feet. Place the bath in the desired position. Note: Waste placement and plumbing requirements should have been determined and prepared by this stage. Once in the desired position adjust the bath feet so that the baths surround is touching the floor. The use of a low profile 2-piece bath waste is recommended.
2. Using the spirit level check to ensure the top edge of the bath is level. If necessary, use the levelling feet to adjust. Adjusting the feet will cause the acrylic surround to lift off the floor.

BATH INSTALL DETAIL LEG

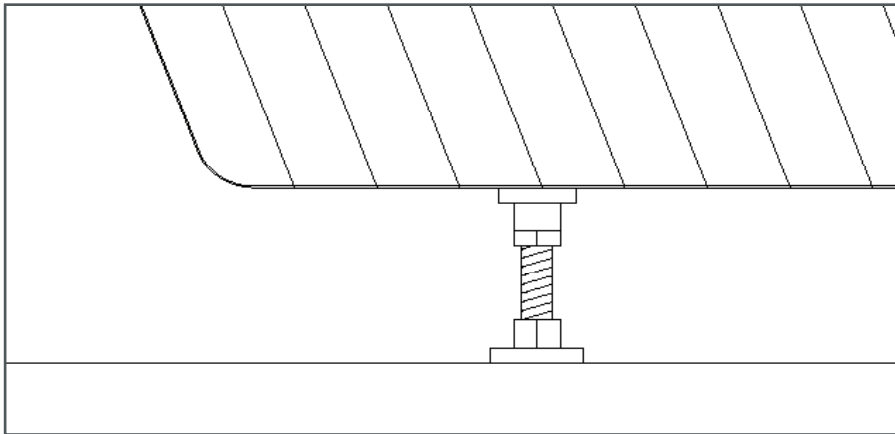

3. Tilt the bath backward and apply an appropriate adhesive to each of the bath feet.
4. Connect the waste and lower the bath into position.
5. Once the bath is in its final position, seal the acrylic surround to the floor and wall using a sanitary grade silicone. For back-to-wall and back-to-wall corner baths, make sure the silicone sealant is applied along the back edge of the bath and top edge of sides of the bath that are adjacent to a wall. For freestanding baths, ensure the silicon sealant is applied along the base edges that are adjacent to the floor.
6. Once silicon has been applied, leave to cure for a minimum of 24 hours with no water.

Additional installation instructions for the Willow, Laurel, Newark & Indus Back-to-Wall and Park Avenue Baths
All Newtech baths must be installed to comply with the NZ building code clause E3/AS1: Internal Moisture

INSTALLING WITHOUT AN UPSTAND - TILES

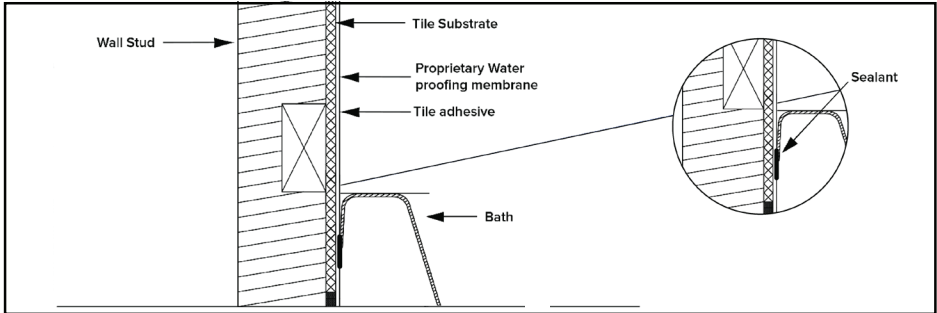

NOTE: This method is not to be used in a shower over bath situation

INSTALLING WITH AN OPTIONAL UPSTAND

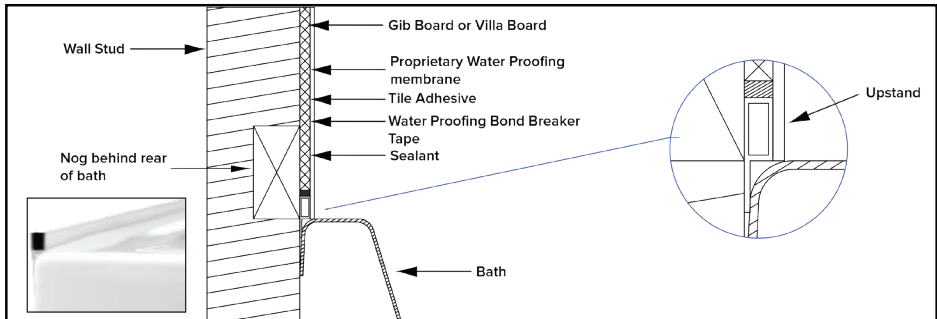

NOTE: When installing a shower over a bath, an upstand must be installed in accordance with the NZ Building Code.



DO NOT RUN WATER UPON INSTALLATION FOR 24 HOURS

SEALING BATH TO FIXTURE RIMS AND EDGES

Waterproof membrane systems must be sealed to the rims and edges of fixtures within the wet area:

- Exposed junctions between the waterproof membrane system on a wall and the rim of fixtures such as cabinets, tubs, or wash hand basins or the edges of cabinets, shall be made watertight by sealant. However, sealant is not required along the bottom edge of wall-mounted fixtures which do not extend down to the floor (in all cases the membrane must nevertheless extend up the wall behind fixtures adjacent to walls).
- For shower trays or baths where the rim meets a wall protected by a waterproof membrane system, secondary linings, eg an acrylic liner, self-finished sheet linings, or sheet linings with secondary wet area membrane and any over-surface finish such as tiles, must be provided, and must lap over the rim to allow water to drain into the shower tray or bath.
- Other than at shower trays and baths, the junctions between the waterproof membrane system and the base of fixtures which meet the floor, eg cabinets and vanities, must be sealed.

For further information on membrane systems, please refer to the NZ Building Standards, Code of Practice for Internal Wet-area Membrane Systems.

WARRANTY INFORMATION

Newtech warrants that products or product components manufactured and distributed by Newtech:

- Meet or exceed the standard requirements of the New Zealand Building Code in particular Clause E3 - Internal Moisture; and
- Will be free from inherent defects in materials and workmanship for the extended warranty period applicable to the product.

Newtech will provide a replacement product or replacement part (or the nearest equivalent) free of charge where a product is covered by our warranty. Any remedial works will not be covered by Newtech.

The Newtech warranty will not apply where the product has been improperly installed, has been misused, proof of purchase cannot be provided or where the warranty claim has not been notified to Newtech within three months of the problem first appearing.

To make a warranty claim, the appropriate documentation must be emailed to: sales@newtech.co.nz with the Name/model of product and photographs of the issue; Proof of installation by a licensed plumber and/or proof of purchase; Your contact details; name, address and best contact phone number.