

SPECIFICATION SHEET

Harrow 750 1-Drawer Wall Hung Vanity Newtech Code : 4606

Features

- 1-Drawer Wall Hung Vanity -
- StoneCast 20mm Via Basin [Standard]
- Upgrade options available
- Full Extension Soft Close Drawer with Handle
- Handle upgrade options available
- Dimensions: H420 x W750 x D465



Technical Details

Note: All measurements shown are in millimetres. Sizes are nominal.

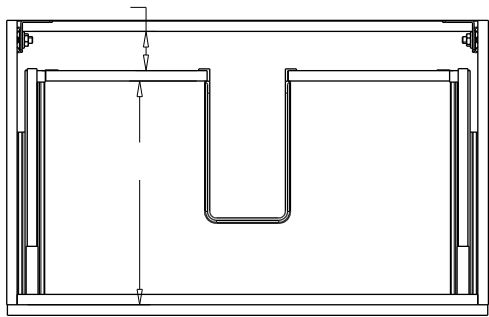

TOP VIEW

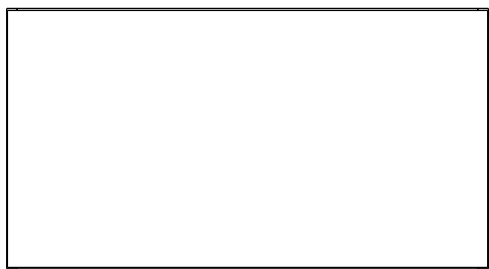
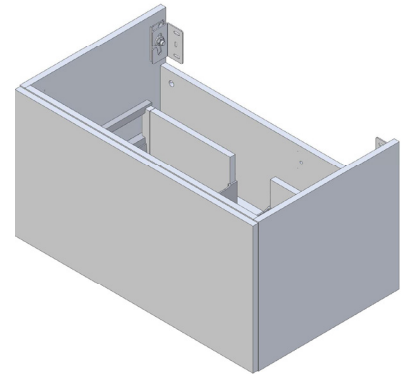

FRONT VIEW

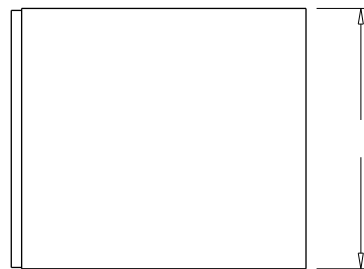

SIDE VIEW