

SPECIFICATION SHEET

Francisco 1200 2-Drawer Wall Hung Vanity, Double Basin

Newtech Code: 4734



Features

- 2-Drawer Wall Hung Vanity with Inset Basin
- Double Basin Vanity
- Full Extension Soft Close Drawers with Handle - *Handle upgrade options available*
- Designer Drawer Front
- Dimensions: H420 x W1200 x D465

See www.newtech.co.nz for the full range of basin, colour and Handle options.

Technical Details

Note: All measurements shown are in millimetres. Sizes are nominal.

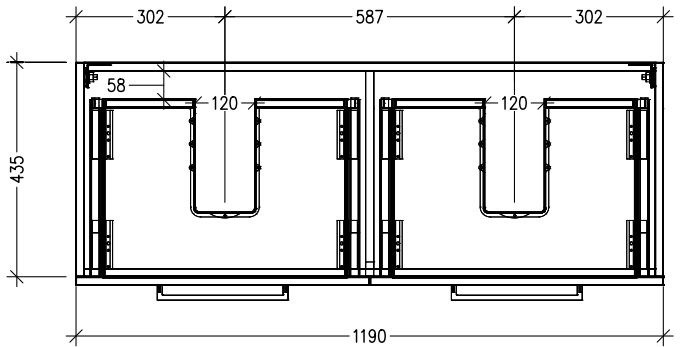

TOP VIEW

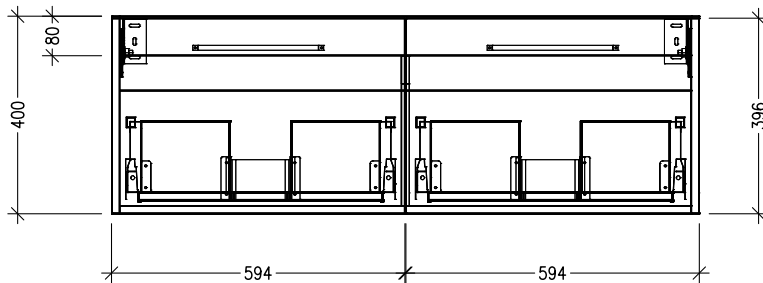
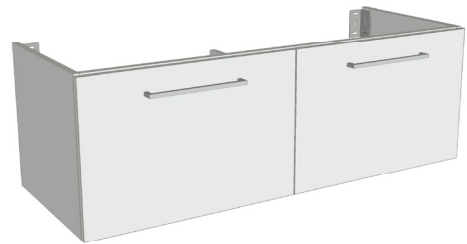

FRONT VIEW

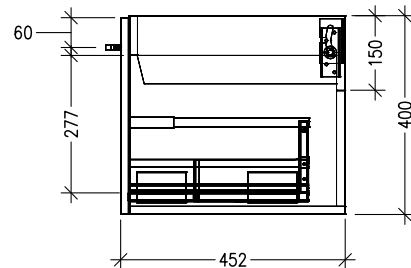

SIDE VIEW

SPECIFICATION SHEET

Francisco 1200 4-Drawer Wall Hung Vanity, Double Basin with cosmetic drawers

Code: COSLR,COSL,COSR

Technical Details

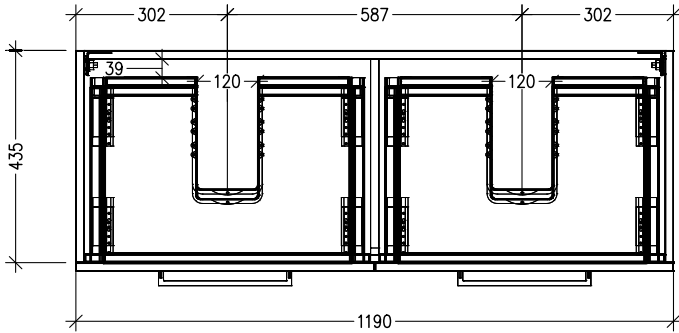

TOP VIEW

Note: Drawings shown are for COSLR. When COSL or COSR is selected please ignore the opposite cosmetic drawer in the drawings as the opposite side would be a full depth drawer.

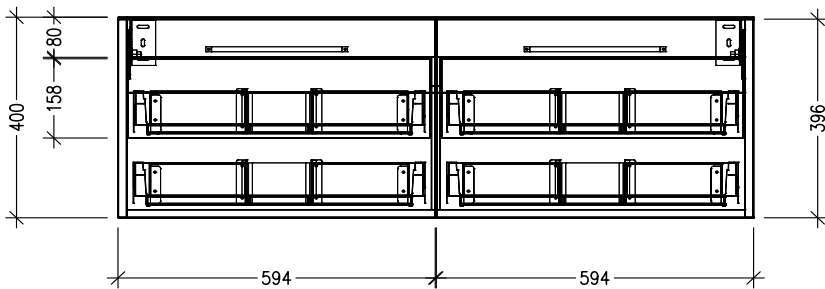

FRONT VIEW

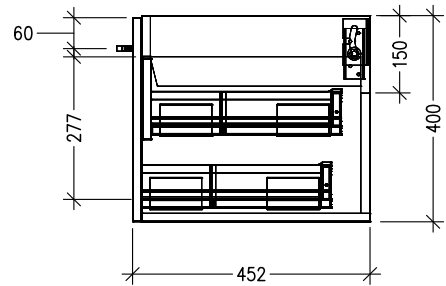

SIDE VIEW

SPECIFICATION SHEET

Designer Drawer/Door Fronts

BARNSLEY
18mm Inset Frame
Code: BL

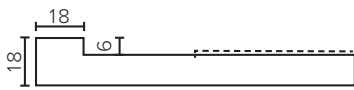
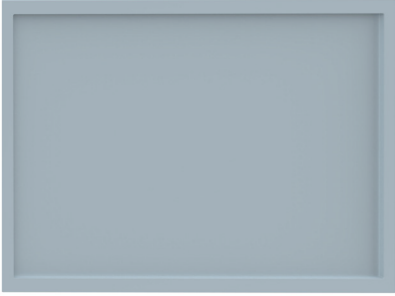

PRESTON
60mm Inset Frame
Code: PT

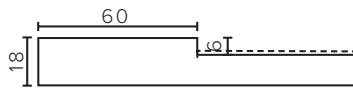
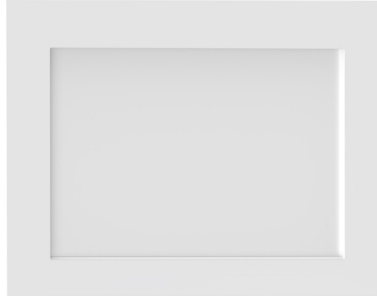

TURNBERRY
Ripple Design
Code: TB

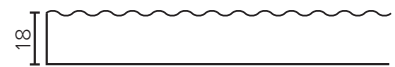

NEWPORT
V-Groove Panels
Code: NP

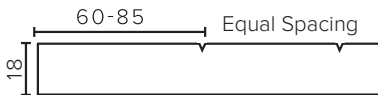

MIAMI
Little Wave
Code: MI

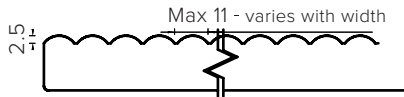
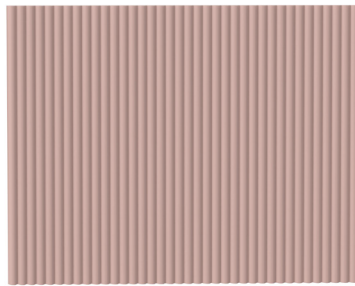

LAUREL
Fluted Lines
Code: LU

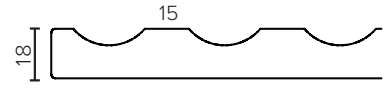

LINCOLN
Fence Style
Code: LN

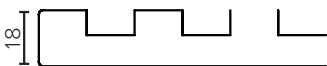
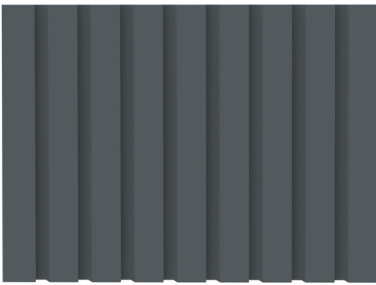

ASPEN
Scallop Wave
Code: AP

