

# INFORMATION SHEET

## Eco Inline Exhaust Kit

Code: 8156

expella  
**VENTILATION**  
SERIES

exclusive to Newtech



### PRODUCT OVERVIEW

The Eco Inline Exhaust Kit by Expella contains all the components needed for an affordable, low voltage, single point inline exhaust system for bathrooms and laundries. The kit contains grilles, ducting and our most compact inline duct fan that is quiet, energy efficient and ideal for installing in tight ceiling spaces. A circular 150mm internal ceiling diffuser is also included, designed to sit discreetly on the bathroom or laundry ceiling and optimise airflow.

### WARRANTY

2 year warranty from date of purchase

### Product Features

- Convenient all in one ventilation kit containing everything required to install a single point inline exhaust system in a bathroom or laundry
- Low voltage (24 volt) inline duct fan with an EC brushless motor and maximum exhaust capacity of 125 litres per second
- Low wattage fan is energy efficient and quiet to run
- Compact lightweight fan, ideal for tight ceiling spaces
- Fan has a mounting plate, 3 pin plug and 1.5m cord for easy on-site installation

### Kit Contents

- 1x Low Voltage Inline Duct Fan
- 1x Mounting platew
- 1x6 metre length duct – Uninsulated 4 Zero Flex, 150mm
- 1x external grille – Half Chevron Grille, Plastic, 150mm
- 1x 4m length tape, Reinforced Acrylic Foil 75mm
- 2x O rings
- 4x Cable ties

### Manufacturer

expella™

### Fan Specifications (Low Voltage Inline Duct Fan)

- Suitable Applications - Domestic bathrooms and laundries
- Material - Light Weight ABS
- Duct Size - 150mm
- Maximum Length - 10m
- Energy Consumption  
Volts 24  
Wattage 20  
Amps<sup>2</sup> (maximum) 0.8
- Air Extraction - 452 Volume (m<sup>3</sup>/hr) - 125 Volume (L/s)<sup>3</sup>
- System Pressure (Pa) - 142
- Noise (dBA)\* = 44.4

\*Measured at 3 metres

### Performance

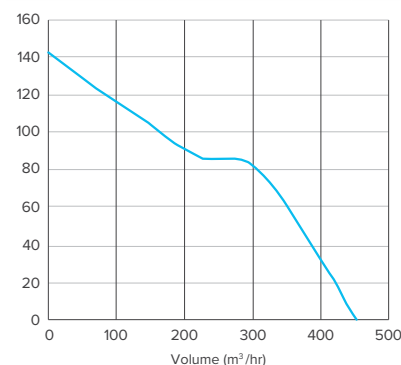

# INSTALLATION INSTRUCTIONS

## Eco Inline Exhaust Kit

Code: 8156

expella  
**VENTILATION**  
SERIES

exclusive to Newtech

### Installation

All components required for installation of the Eco Inline Exhaust Kit are included. The Low Voltage Inline Duct Fan has a 3 pin plug and requires a general power outlet along with duct and external grille installation. Installation by an industry professional (e.g. electrician or builder) or experienced home handyman is recommended. A mounting plate for the fan is included. Fix the fan in a suitable location between the inlet location and discharge location ensuring it is accessible for future maintenance.

Note that sharp bends in ducting can interfere with system performance, refer to installation instructions for further information.

The 150mm Circular Internal Grille requires a 160–165mm diameter hole to be cut into the ceiling. Exit grille may be installed in either the eave or external wall.

Check product specifications with your tradesperson before ordering.

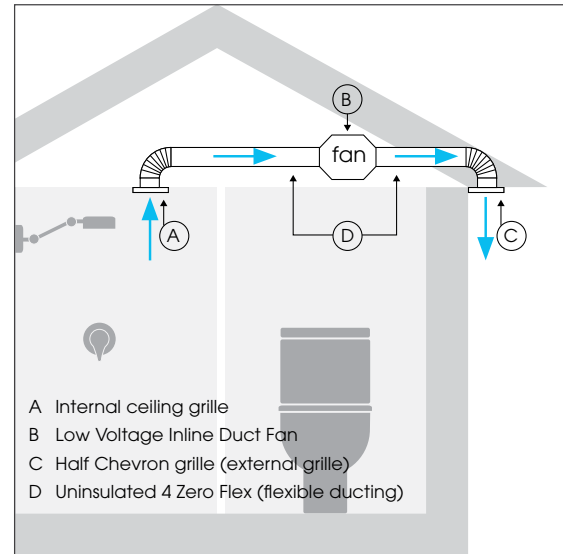

### DIMENSIONS (mm)

#### Low Voltage Inline Duct Fan and Mounting Bracket

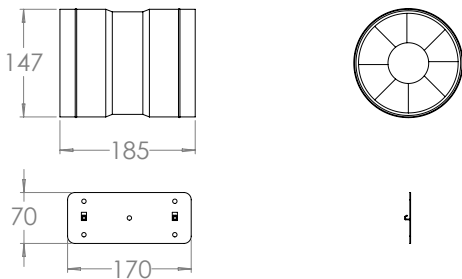

#### Uninsulated 4 Zero Flex

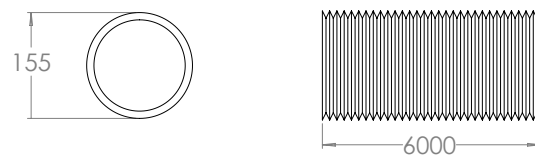

#### 150mm Circular Internal Ceiling Grille

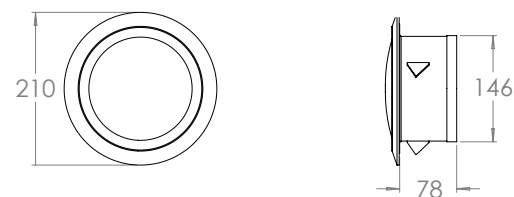

#### Half Chevron Grille, Plastic

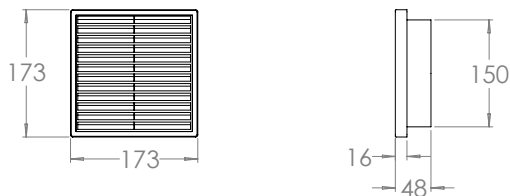

### MAINTENANCE/CLEANING

Periodic inspections and cleaning of the fan are required to prevent dirt, dust or lint accumulating on fan impeller. Fan must be disconnected from the power supply (unplug fan plug) before removing the motor.