

INSTALLATION INSTRUCTIONS

Anodized Aluminium Weatherproof Louvre with Box

Code: 8190 (200mm), 8191 (300mm)

exclusive to Newtech

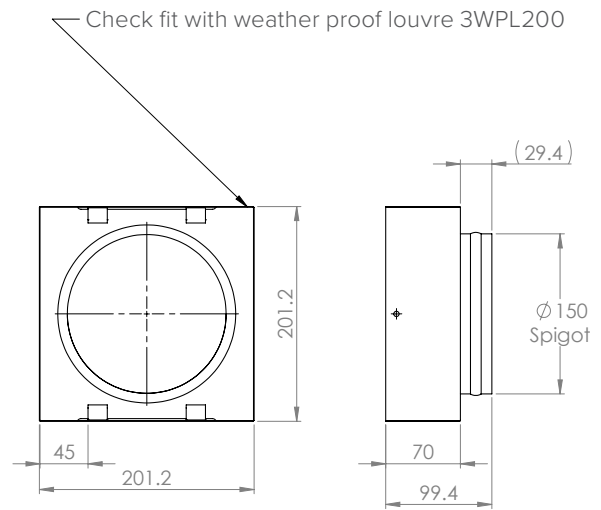

PRODUCT OVERVIEW

Weatherproof louvre is made from a high quality aluminium exterior grille.

These grilles comes with a snap-in box making installation a breeze.

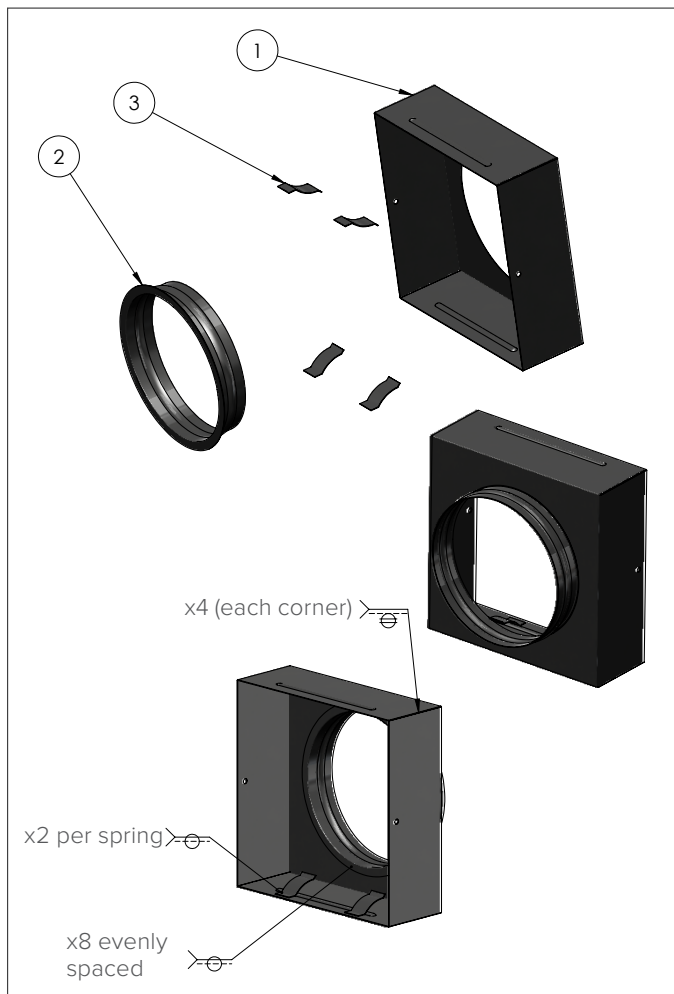

Item	Description	Qty
1	3BBL200_Box	1
2	3BBL200_Spigot	1
3	3BBL200_SpringClip	4

NOTES

- Material: refer to flat pattern note for material and sheet thickness.
- Finish: powdercoat, satin black
- Weld part per aws standards.
- All fold dimensions are taken from outside the fold. Use minimum bend radius and minimum bend relief.
- Break and deburr all sharp edges.
- The 2D CAD file is the controlling document from which this part must be fabricated. Dimensions shown will be used for inspection process. Use the following tolerances for fabrication of the part in conjunction with the CAD file for features not specified in this drawing:
 - Hole to hole: ± 125
 - Edge to hole: ± 125
 - Fold to hole: ± 25
 - Edge to edge: ± 25
 - Fold to edge: ± 50
 - Fold to fold: ± 75

INSTALLATION INSTRUCTIONS

Anodized Aluminium Weatherproof Louvre with Box

Code: 8190 (200mm), 8191 (300mm)

BODY

201.2

201.2

201.2

70

0.6

70

SECTION A-A

Typical form for spring clips.
Manufacturer to position as standard

129.8

339.5

199.9

199.9

339.5

152

2 x $\phi 5$

10

x4 (each corner)

FLAT PATTERN:
VIEW SCALE 1:4

- Material: Plain Carbon Steel
- Thickness: 0.6mm
- The flat pattern depicted in this view is for the part: **3BBL200 REV A**.
- Flat pattern and flat pattern dimensions are shown for reference only. Part is to be created from the dxf file.

SPIGOT

$\phi 166.8$

C

30.6

0.6

Use available form tool to create indent

Roll, overlap and and join as standard

$\phi 150$ O.D.

10

SECTION C-C

MATERIAL:
Plain Carbon Steel

SPRING CLIP

Standard spring clip

18

INSTALLATION INSTRUCTIONS

expella
VENTILATION
SERIES

exclusive to Newtech

Anodized Aluminium Weatherproof Louvre with Box

Code: 8190 (200mm), 8191 (300mm)

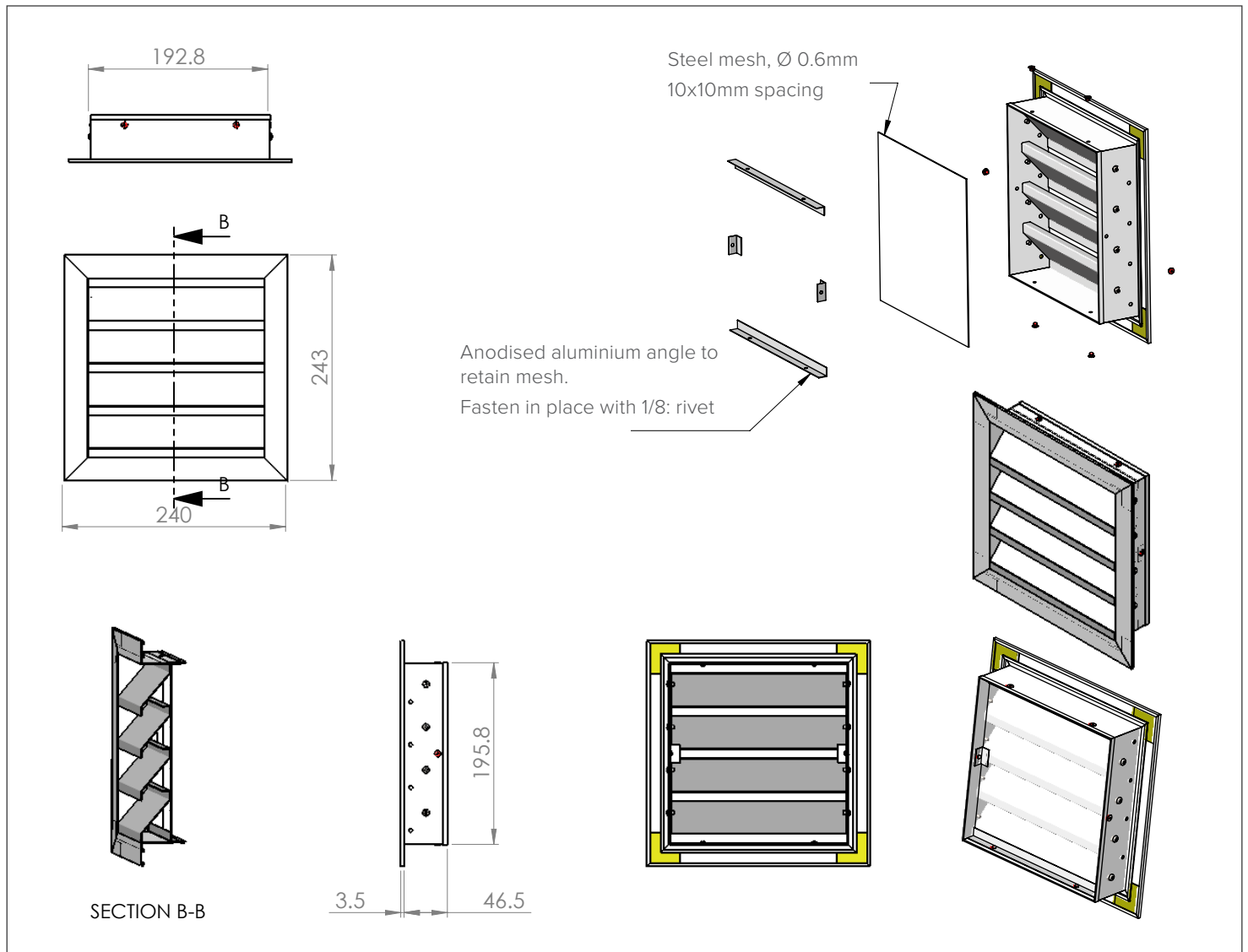

NOTES

- Material: refer to notes
- Finish: Satin Natural Anodise
- For use with exit box pn: 3BBL200
- Break and deburr all sharp edges.
- The 3D CAD file is the controlling document from which this part must be fabricated. Dimensions shown will be used for inspection process. Use the following tolerances for fabrication of the part in conjunction with the cad file for features not specified in this drawing:
 - General tolerance ± 0.3 mm linear
 - ± 0.5 Angular.
- Dimensions shown do not include finish/coating thickness.

CONTACT US