

# INSTALLATION INSTRUCTIONS

## Slimline Wall/Ceiling Fan

Code: 8179

expella™  
**VENTILATION**  
SERIES

exclusive to Newtech



### PRODUCT OVERVIEW

The Slimline Wall/Ceiling Fan has a low profile, flat cover making the fan minimal and discreet. It is suitable for wall or ceiling mounting and is an effective exhaust solution for a variety of domestic and commercial applications.

### APPLICATION

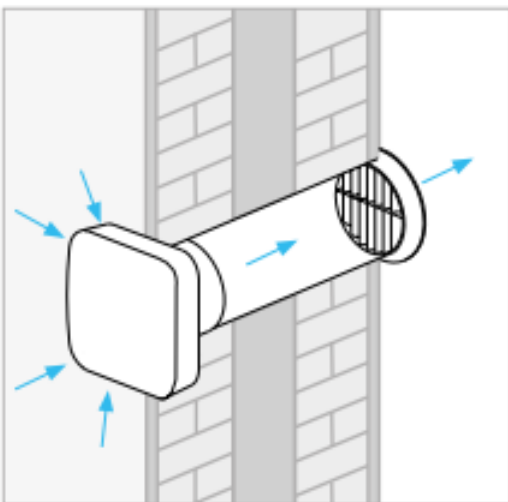

Image 1 – Wall Installation

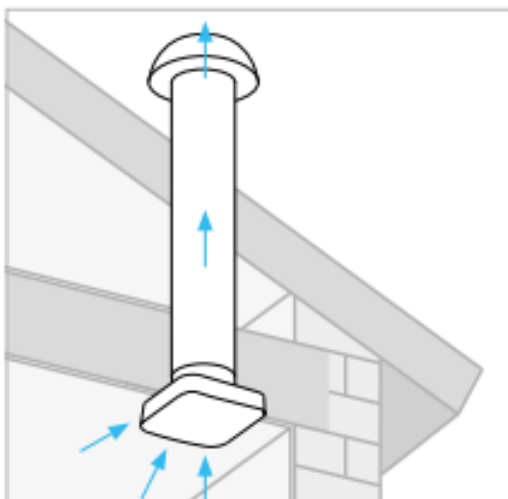
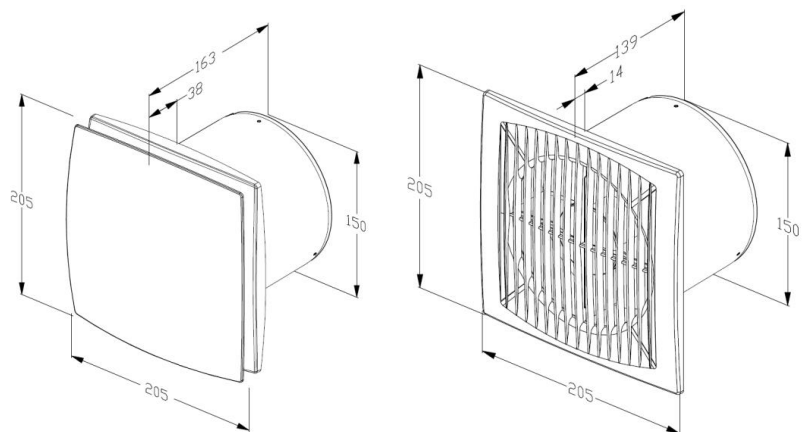

Image 2- Ceiling Installation

### DIMENSIONS



This wall fan is an axial fan for exhausting directly outside through short lengths of ducting and is suitable for wall or ceiling installation.

Please read this manual carefully to ensure optimum operation and long life.

Do not use this product for uses that are different from those for which it has been designed (outlined hereafter).

After removing product from packaging ensure that it is complete and undamaged.

# INSTALLATION INSTRUCTIONS

## Slimline Wall/Ceiling Fan

Code: 8179

expella™  
**VENTILATION**  
SERIES

exclusive to Newtech

### WALL / WINDOW INSTALLATION

**Step 1** - Cut or core hole 155mmØ hole in wall or window

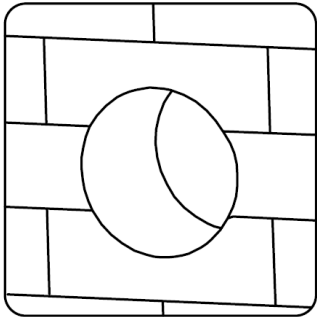

Wall install hole 155mmØ

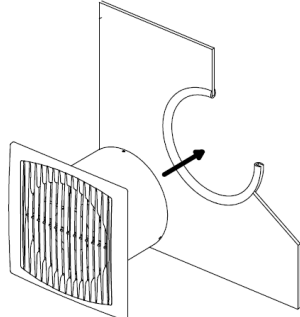

Window hole 155mmØ

**Step 2** - Remove fan fascia by loosening screws.

**Step 3** - Insert fan housing into mounting hole and mark fixing screw locations and power inlet hole.

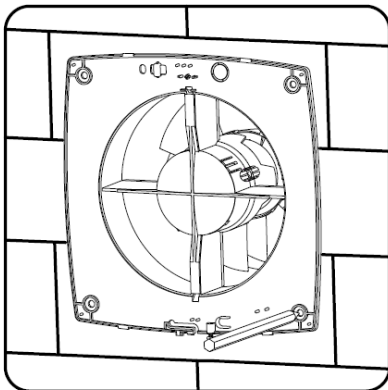

Mark fixing hole locations

**Step 4** - Drill 4 x 5mm Ø holes where marked and insert wall plugs.

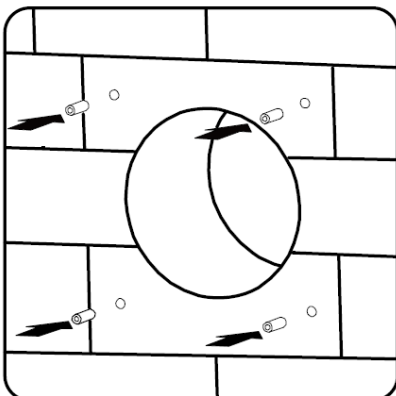

Insert wall plugs

**Step 5** - Run power to fan location.

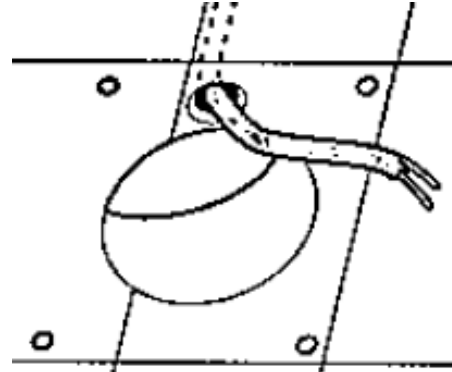

Run power to fan location

**Step 6** - Insert fan housing into hole and fix in position using screws provided. For window installation, mount rubber profile to edge of glass hole.

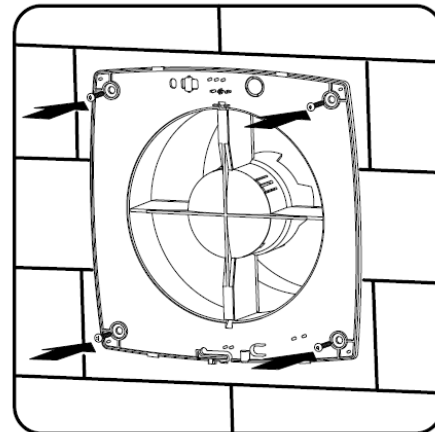

Fix fan to wall

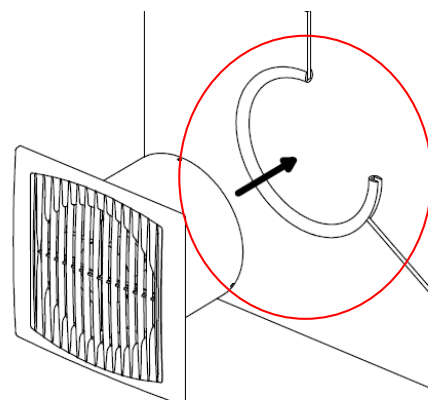

Fix fan to wall

# INSTALLATION INSTRUCTIONS

## Slimline Wall/Ceiling Fan

Code: 8179

expella™  
**VENTILATION**  
SERIES

exclusive to Newtech

### WALL / WINDOW INSTALLATION continued

**Step 7** - Connect power to terminal and fix fan facia.

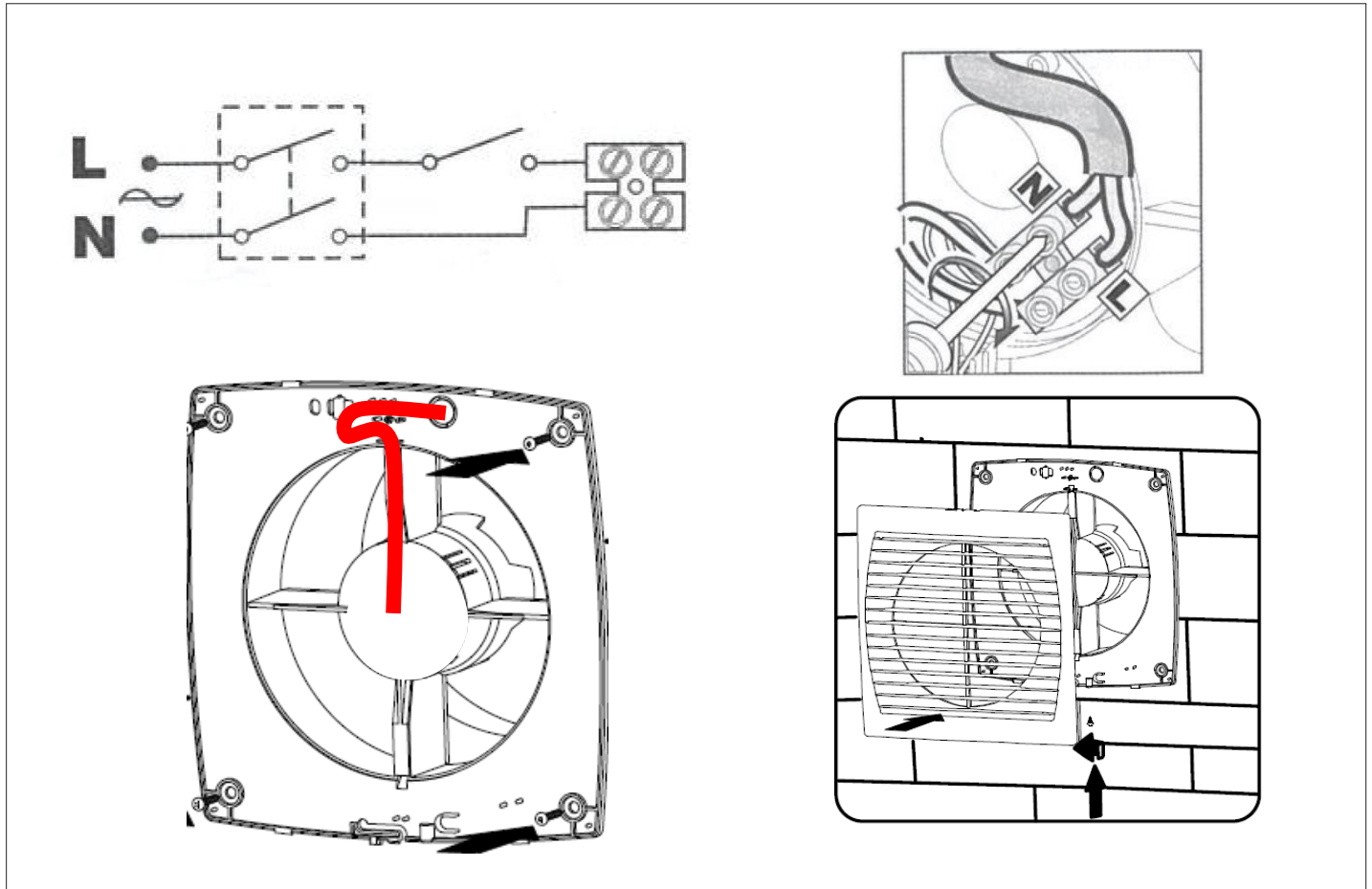

NOTE: The fan has an integrated back draft damper. Please ensure clear unobstructed clearance of 200mm from back of fan to ensure dampers can open and close freely.

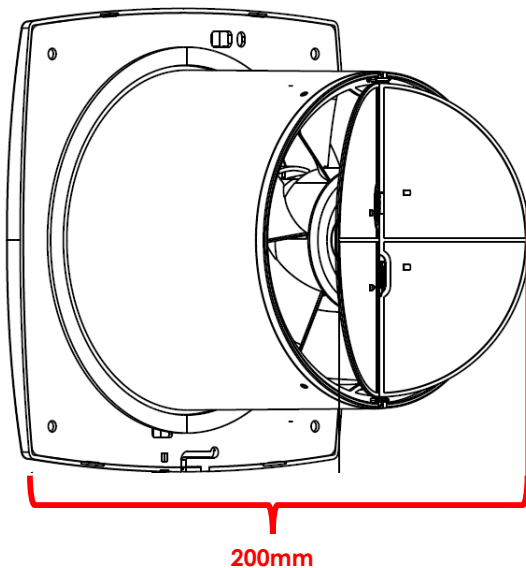

200mm

# INSTALLATION INSTRUCTIONS

## Slimline Wall/Ceiling Fan

Code: 8179

expella™  
**VENTILATION**  
SERIES

exclusive to Newtech

### CEILING INSTALLATION

**Step 1** - Make a frame (suggest timber) as below and place above ceiling.

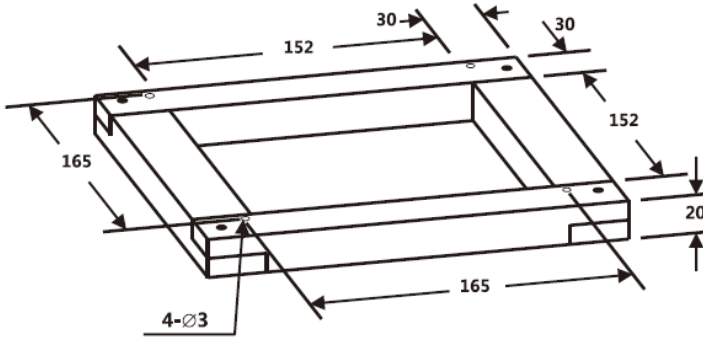

**Step 2** - Cut or core hole 155mm Ø hole in ceiling.

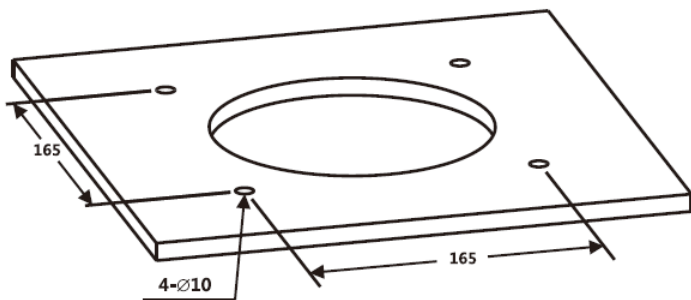

**Step 3** - Insert fan housing through hole and fix through ceiling to the frame.

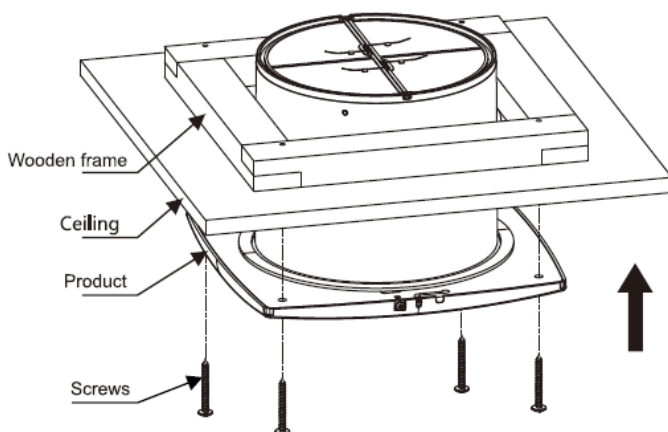

**Step 4** - Connect ducting with clamp or cable tie and seal with silver tape.

Please ensure there is no bend within 200mm from fan to allow back draft dampers to open. Ensure ducting does not restrict movement of back draft dampers

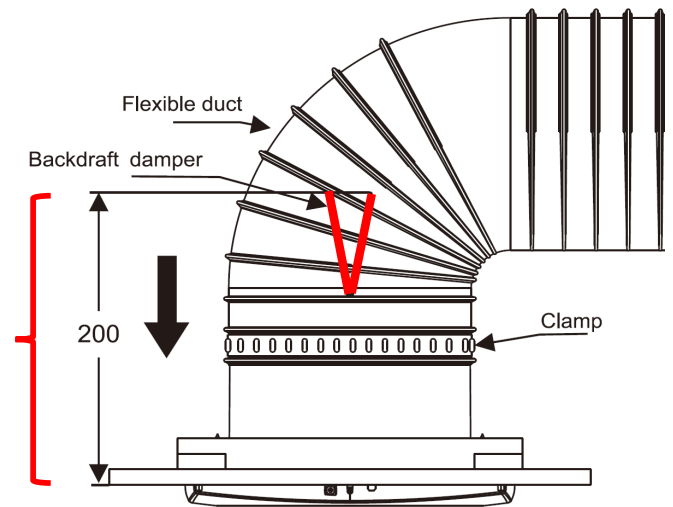

# INSTALLATION INSTRUCTIONS

## Slimline Wall/Ceiling Fan

Code: 8179

expella™  
**VENTILATION**  
SERIES

exclusive to Newtech

### AFTER INSTALLATION

#### Before starting the fan please ensure that:

- The fan is secured and electrical connection is correct
- No loose material is in the fan or ductwork
- Ensure fan blade can spin freely
- The earth fittings are adequately secured
- The electrical safety devices are correctly connected
- Wiring and electrical connections are adequately sealed and water-tight
- Working temperature from -20°C – 60°C
- Make sure there are no loose elements near fan intake
- Before connecting the fan, ensure mains power supply is disconnected

---

### WARNING

1. Installation and wiring must be carried out by qualified electrician and in accordance with New Zealand Electrical standards.
2. This fan is not intended for use by persons (including children) with reduced physical, sensory or mental capabilities, or lack of experience and knowledge, unless they have been given supervision or instruction concerning use of the appliance by a person responsible for their safety.
3. Do not touch the fan with wet or humid parts of the body (ie. Hands)
4. Children should be supervised to ensure that they do not play with the appliance.
5. If the power cord is damaged, the cord must be replaced by a qualified electrician in order to avoid a hazard.
6. Fan should be installed more than 2.1m above ground.
7. Do not reduce diameter of ducting from the outlet of the fan.
8. Ensure there are no bends in the ductwork within 200mm of the fan. Placing a bend within this distance will significantly restrict fan performance and may prevent back draft dampers from opening.
9. Keep duct work as straight as possible. Avoid sharp bends within 200mm of fan outlet
10. Avoid placing any pressure on fan wheel during installation and cleaning.
11. If unusual oscillating movement is observed, immediately stop using the fan and contact the manufacturer, it's service agent or suitably qualified persons.
12. Exhaust fans may adversely affect the safe operation of appliances burning gas or other fuels (including those in other rooms) due to back flow of combustion gases. These gases can potentially result in carbon monoxide poisoning. After installation of an exhaust fan such as a partition fan or duct fan the operation of flued gas appliances should be tested by a competent person to ensure that back flow of combustion gases does not occur.

---

### MAINTENANCE/CLEANING

Before cleaning the fan, ensure it is disconnected from mains power. Cleaning of the fan should be undertaken when there is significant build-up of dust visible on the intake of the diffuser or propeller.

Failure to maintain the fan may shorten the working life of the fan.

### WARRANTY

2 year warranty from date of purchase

---

### CONTACT US



30 Mill Road, Whanganui  
0800 728 662

sales@newtech.co.nz  
www.newtech.co.nz